

ŞEHREMİNİ GRUP

GAYRİMENKUL GELİŞTİRME || ENERJİ || SAĞLIK



ŞEHREMİNİ GRUP

2011 yılında ticari faaliyetlerine başlayan Şehremini Grup temel olarak Gayrimenkul Geliştirme, Enerji ve Sağlık sektörlerinde faaliyet göstermektedir. Bu sektörlerde yer alan şirketleri aracılığıyla ticari faaliyetlerine devam etmektedir. İlgili sektörlerdeki şirketlere ilişkin bilgiler ise aşağıda sizlerle paylaşılmaktadır:

2011 yılında faaliyetlerine başlayan, kamu kurumları ve özel sektöre yönelik proje ve müşavirlik hizmetleri vererek gelişimine devam eden **ŞEHREMİNİ PROJE DAN. İNŞ. MİM. MÜH. SAN. TİC. LTD. ŞTİ.** kadrosunda yer alan tecrübeli şehir plancıları, mimarlar, iç mimarlar ve alanında tecrübeli mühendislerle sektörde hizmet sunmaktadır. **Şehremini Proje olarak;** Organize Sanayi Bölgeleri, Özel Endüstri Bölgeleri, Yenilenebilir Enerji Projeleri ve özel sektör yatırımları geliştirilmiş yine hastane, adalet sarayı, kamu hizmet binaları ve Eğitim yapıları projelendirilerek sonuçlandırılmıştır.

Kuruluşundan bugüne kadar proje geliştirme hizmetleri veren firmamız, firma ortaklarının aldığı karar sonrası 2017 yılı Ocak ayında geliştirdiği projelerde yüklenici olarak da yer almak amacıyla **ŞEHREMİNİ YAPI İNŞ. KUR. HİZM. SAN. VE TİC. A.Ş.** aracılığıyla yapım ve taahhüt sektörüne katılarak Gayrimenkul Geliştirme alanındaki yatırımlarına devam etmiştir.

Dünyanın ve ülkemizin gelişimiyle birlikte artan enerji ihtiyaçlarını düşünerek, dünyada artan yeşil enerji yatırımlarında yer almak ve Paris İklim Anlaşması ile dünyanın yeşil enerji dönüşümünden pay almak adına 2021 Eylül ayında şirketimizin de kurucusu olduğu **MCA YENİLENEBİLİR ENERJİ YATIRIM SAN. VE TİC. A.Ş.** kurucu ortak olarak yer almış ve yenilenebilir enerji yatırımlarına yönelik proje geliştirme, uygulama ve işletme süreçlerine yönelik çalışmalara başlamıştır. **MCA Enerji olarak;** Ülkemizin önde gelen Şirketlerinden Nuh Çimento, Efesan Grup ve Koç Holding iştiraki Entek Elektrik ve Ford Otomotiv A.Ş gibi şirketlerle halihazırda yenilenebilir enerji projeleri yürütmektedir.

2020 yılı kuruluş sürecinden bu yana, planlama ve fizibilite çalışmalarında yer alınan Balıkesir ili Bandırma ilçesinde kurulan Marmara Yüksek Teknoloji ve Makine İhtisas OSB içerisinde kurulmuş ve 5.000 m2'lik ön tahsis yapılan sanayi parseli üzerinde, **ACS MARMARA İNŞ. İTH. İHR. SAN. TİC. A.Ş.** olarak Türkiye ve Dünya ekonomisindeki gelişmeleri de dikkate alarak yerli ve milli üretimin yanında ihracat yapılması hedeflenmektedir.

Yine içinden geçtiğimiz pandemi süreci sonrası; insan hayatının temel ihtiyacı olan sağlık hizmetinin tüm aşamalarının en hızlı, en etkili, en kapsamlı ve en kolay ulaşılabilir şekilde olmasını sağlamak ve ilaç temini, nitelikli sağlık hizmeti sunmak gayesiyle 2022 Ağustos ayında **ENR İLAÇ MEDİKAL SAĞLIK TURİZMİ İTH. İHR. SAN. TİC. A.Ş.** bünyesinde ortak olarak yer alarak sağlık alanındaki yatırımlara başlanmıştır. A gurubu seyahat Acentası belgesi sahibi olarak Sağlık Turizmi hizmetleri verme imkanına sahip olan şirketimiz yine Türkiye İlaç ve Tıbbi Cihaz Kurumu'ndan 2023 yılı Eylül ayında alınan ruhsat ile Eczacı deposu da hizmet girmiş ve ilaç ve medikal ürün ticaretine başlanmıştır.

Şirket ortakları olarak içinde yaşadığımız dünya ve ülke dinamiklerini takip ederek, farklı sektörlerde, imkanlar çerçevesinde yatırım yapmaya çalışıyor, bu sayede ülkemiz ekonomisine ek istihdam imkanları ve katma değer katma hedefi ile çalışmalarımıza devam ediyoruz...



Eyüp Cendel ERSOY
Şehir Plancısı
Yön. Kur. Bşk.

Sidre Dilara ERSOY BİÇME
Yüksek Mimar
Yön. Kur. Bşk. V.



ŞEHREMINİ GROUP

Started commercial activities in 2011, Şehremini Group mainly operates in Real Estate Development, Energy and Healthcare sectors. Through its companies in these sectors, Şehremini Group continues its commercial activities. Information on companies in the relevant sectors is provided below: **ŞEHREMINİ PROJE DAN. İNŞ. MİM. MÜH. SAN. TİC. LTD. ŞTİ.** which started its activities in 2011 and proceeds to develop by providing project and consultancy services for public institutions and private sector, offers services in the sector with experienced city planners, architects, interior architects and experienced engineers in the field. **As Şehremini Project;** Organized Industrial Zones, Private Industrial Zones, Renewable Energy Projects and private sector investments have been developed and also, hospitals, courthouses, public service buildings and education facilities have been designed and finalized.

Our company, which has been providing project development services since its establishment, continued its investments in Real Estate Development following the decision taken by the company's partners in January 2017, by joining the construction and contracting sector through **ŞEHREMINİ YAPI İNŞ. KUR. HİZM. SAN. VE TİC. A.Ş.** in order to take part as a contractor in the projects it developed.

Considering the increasing energy needs with the development of the world and our country, to be involved in the ever-increasing green energy investments and to take a share in the green energy transformation of the world with the Paris Climate Agreement, **MCA YENİLENEBİLİR ENERJİ YATIRIM SAN. VE TİC. A.Ş.**, of which our company is the founder, took place as a founding partner in September 2021 and started to work on project development, implementation and operation processes for renewable energy investments. **As MCA Enerji,** we currently carry out renewable energy projects with leading companies in our country such as Nuh Çimento, Efesan Group, Ford Otomotiv A.Ş and Koç Holding subsidiary Entek Elektrik.

Since the foundation in 2020, as **ACS MARMARA İNŞ. İTH. İHR. SAN. TİC. A.Ş.**, which has been involved in planning and feasibility projects and established on a pre-allocated industrial parcel of 5,000 m2 in the Marmara High Technology and Machinery Specialized Organized Industrial Zone located in the Bandırma district of Balıkesir province, we aim to export along with the domestic and national production taking into account the economic developments of Turkey and the world.

In the aftermath of the pandemic, with the aim of ensuring that all stages of health care, which is the basic need of every human, are provided in the fastest, most effective, most comprehensive and most accessible way, and to provide medication supply and qualified health care services, we became a partner of **ENR İLAÇ MEDİKAL SAĞLIK TURİZMİ İTH. İHR. SAN. TİC. A.Ş.** in August 2022 and started to invest in the field of health. Our company, which has the opportunity to provide Health Tourism services as a Group A Travel Agency certificate holder, has also introduced a pharmaceutical warehouse service with the license obtained from the Turkish Medicines and Medical Devices Agency in September 2023 and started to trade pharmaceuticals and medical products.

As company partners, we try to invest in different sectors in line with our own means by following the dynamics of the world and the country we live in, and in this way, we carry on our work with the aim of providing additional opportunities for employment and contribution to our country's economy.



Eyüp Cendel ERSOY
City Planner
CEO

Sidre Dilara ERSOY BİÇME
Master Architect
Acting CEO



" ŞEHREMINİ " مجموعة " شهرميني "

لصاوت ذا .يراقع لريوطتلاو،ةقاطلاو ،ةحصلا تاعاطق يف يسيئر لكشبو ،2011 مرا ع يف ةيراجتلا اهتطشنأ ةسرامرب ،" Şehremini " يني مرهش " ةومرجم تأدب يف ةطشنلا تاكشرلاب ةقلعتمرلا تامرولعمرلا مكرتكارشمره هاندأ مروقنسا انناف ،هيعلو .تاعاطقلا كلت يف ةلاعفل اهتاكشر لال خ نم ةيراجتلا اهتطشنأ ةراجتلاو ةعانصلو ةسدنهلو ةيرامعمرلا ةسدنهلو ءانبلو تاءاشنالو ةيراشتسالا تامرخلو عيراشمرلل " Şehremini " يني مرهش " ةكشر لصاوت:ةلصل تا ذتاعاطقلا يف تامرذ مريدقت لال خ نم اروطت ، 2011 مرا ع يف اهتطشنأ ةسرامرب تأدب يتلا ، " ŞEHREMINİ PROJE DAN. İNŞ. MİM. MÜH. SAN. TİC. LTD. ŞTİ. " ةودو حمرلا ني طخمرلا لال خ نم ،كلت تاعاطقلا اهتامرذ مريدقت ةكشر لال نا امك .صاخلا عاطقلا وأ ةماعلا تاسسؤممرلل تناك نا ءاوس ةيراشتسالا تامرخلو ،عيراشمرلا " عيراشمرلل " Şehremini " يني مرهش " اهتفصبو .مهتالاجم يف ةربخلل يوذ ني سدنهمرلا ،يلخالل روكيدلا يمرصمو ،ني يرامعمرلا ني سدنهمرلا ،ني يرضحل نع الرضف ،صاخلا عاطقلا يف تارامثتساب مرايقلو ،ةددجتمرلا ةقاطلا عيراشمر ،ةصاخلا ةيعانصل قاطنمرلا ،ةمظرنمرلا ةيعانصل قاطنمرلا ريوطت مرت هناف ؛ ،ةكشر لال اهتاكشر هذختا يذلا رارقلا دعبو .ةيمرليعتلا ينيابمرلا ،ةماعلا تامرخلل ينيابمر ،لدعلا روصقو ،تايفشستسمرلا ريوطتو ءانبو دييشتو مريدصت عيراشمرلا ريوطت لاجم يف تامرذ مريدقت يتلا انتكشر تالصلو ،2017 ريان/ينانثلا نوناك يف اهريوطت مرت يتلا عيراشمرلا يف لواقمرك ةكراشمرلا ضرغبو ،تالواقمرلاو تاءاشنالو عاطق يف ةكراشمرلا قيرط نع يراقعلا ريوطتلا لاجم يف اهتارامثتسا كلكو ،رضاحلا انموي يلاو اهسي سسات ذنم " ŞEHREMINİ YAPI İNŞ. KUR. HİZM. SAN. VE TİC. A.Ş. " ةمهاسمرلا ةراجتلاو ةعانصلو تاءاشنالو سي سياتللو ءانبلو تامرذم " Şehremini " يني مرهش " ةكشر لال خ نمو يلع لوصحل لاجم نم كلكو ، ملعلا يوتسم يلع وأ اندلب يوتسم يلع ناك نا ءاوس يراجلا روطتلا عم ةقاطلل ةديازتمرلا ةحلمرلا ةجالحا رابتعلا رظنبا ذخال دنعو ءارضحلل ةقاطلا لاجم يف ةيراجل تارامثتسالا يف ةكراشمرلا ،خانمرلل سيراب ةيقافتا ذيفنت راطا يف يراجل ملعلا يف ءارضحلل ةقاطلا لوحت نم ةصح ةمهاسمرلا ةراجتلاو ةعانصلو رامثتسالاو ةددجتمرلا ةقاطلل " MCA " ي ايس مرأ " ةكشر تعرش ،موي دعب اموي ملعلا يف ةديازتمرلا ل حارم يف لمعلا ب تعرش ،2021 ربمربس /لولي رهش يف ،ةسسؤممرلا ةكشر لال انتكشر ربتعت يتلا " MCA YENİLENEBİLİR ENERJİ YATIRIM SAN. VE TİC. A.Ş. " MCA ي ايس مرأ " ةكشر نا امك .سسؤممرلا كيرشلا ةفصبا هيف دجاوتت يتلاو ةددجتمرلا ةقاطلا تارامثتساب ةقلعتمرلا عيراشمر زاجانو ذيفنتو ،ليغشت " Nuh " حون ةكشر " ،اهنمو ايكرت يف ةدئارلا تاكشر لال عم رضاحلا انموي يلا ةمرتسمرلاو ةددجتمرلا ةقاطلا عيراشمر زاجانو ذيفنتب موقت ؛ةددجتمرلا ةقاطلل " ةومرجمرلا ءكشر لالو ،" Ford Otomotiv A.Ş " ةمهاسمرلا تارايسلا ةعانصل " Ford دروف "و " Entek Elektrik " ءابرهكلل " Entek كتننا " ةكشر و ،" Nuh Çimento " تنمرسالا " Koç Holding " ةضبالا " Koç شتوك " ةكشر و " Efesan Grup " " Efesan " ناسيف

5000 ةي لالمرجالا اهتحاسم غلبت اقبسم ةصصخم ةيعانص ضرا يلع ، " ACS MARMARA İNŞ. İTH. İHR. SAN. TİC. A.Ş. " " ACS س ايس ي ايس " ةكشر تسسأت ةني دمرل ةعباتلا امري دناب ءاضق يف اهؤاشنن مرت يتلاو تالالو ةي لال اي جولونكتلا يف ةصصختمرلا ةمرمرم ةمظرنمرلا ةيعانصل قاطنمرلا نمضو ،عبرمر رتم اهتفصب " ACS س ايس ي ايس " ةكشر فدهتو .رضاحلا انموي يتحو ،2020 مرا ع يف اهسي سياتللو ةرتف ذنم هيف يودجلاو طي طختلا تاسارد ءارجل مرتي ثيح ،ريسيك يلاب .يمرلعالو يكرتلا داصتقالا يف ةيراجل تاروطتلا رابتعلا رظنبا ذخال عم ،ينطولو يلحمرلا جاتنالو يلا ةفاضلا اب ري دصتلا تاي لمرع ءارجا يلا ،ةي صخشلا عرسأب ،ناسنالا ةايحل ةبسنلاب ةحلمو ةي ساسأ ةجالح ربتعت يتلا ،ةي حصل ةي اعزل ل حارم عيمر مريدقت نامرض فدهب و ؛انوروك ءابو يشفت ةلحرم دعبو ،يرخا ةمرمو ةحصلا لاجم يف تارامثتسا يف لوخدلا ب ءدب مرت هناف ،ةلهؤممرلا ةي حصل تامرخلو ،ةي ئاودلا تاداملل ري فوت كلكو ،ألومشو ،ةي لاعف اهركأو ،قرطل لهسأبو ةراجتلاو ةعانصلو ري دصتلاو داري تسالاو ةي بطلو ةي حصل ةحاي سالاو " ENR رانأ يا " ةكشر ةلظم تحت كيرش ةفصبا لوخدلا لال خ نم ،2022 ب ايس /سطسغا يف ةداهشل ةلمرح اهرا بعتاب ةي حصل ةحاي سالاو تامرذ مريدقت صرفب انتكشر عتمرتت امك . " ENR İLAÇ MEDİKAL SAĞLIK TURİZMİ İTH. İHR. SAN. TİC. A.Ş. " ةمهاسمرلا نم صيخرت يلع لهلوصح عم ةي و دألل نزممك عاطقلا لهلوخد كلكو ،ةي بطل تاجتنتمرلاو ةي و دأل ةراجت يف ءدبلا يلا ةفاض ،" A ي ايس ةومرجمرلا " عون نم رفس ةلاكو ملعلاو دلبلا يف ةيراجل تاروطتلاو تاي كيرمان يلا ارضي اعباتن انناف ،ةكشر لال يف ءكشر و .2023 ربمربس /لولي يف ةي كرتلا ةي بطل ةزهجالو ةي و دأل ةلاكو لمع صرف ةفاضل فدهب انلمع لصاون انناف يلاتلابو ،ةنهارلا انتاي ناكمرا راطا يف ةفلتخم تاعاطق يف رامثتسالاو عسنو ،هيف شيعن يذلا ..ان.دلب داصتقال ةفاضم ةمري قو ،ةيفاضل



همرشيبيوسرارا ليد هرديس
يرامعمر ةسدنه ريتسجام
ةكشر لال ةرادا سلجم سيئر ليكو

يوسرلا لادناج بوي
يررضح طخمر
ةكشر لال ةرادا سلجم سيئر





ANKARA YILDIRIM BEYAZIT UNIVERSITY STUDENT LIFE CENTER

It is a Student Life Center project of Yıldırım Beyazıt University planned to be built in Dumlupınar neighborhood of Çubuk district of Ankara province. The project has a construction area of 13,500 m², consisting of an administrative building, a dining hall, a sociocultural facility for students, and a conference room. Within the project, the basic functions (administrative building, cafeteria, commercial building and conference hall) interrelated with each other are spatially linked through the social backbone axis. There is a refectory building at the main entrance to the project area. By leaving a semi-open area in the middle of this mass, an uninterrupted circulation was ensured from the main road to the axis of the social spine. The pedestrian path that intersects the axis of the main spine horizontally separates the refectory mass from the conference hall and the commercial building. By limiting the vehicle access areas to remain on the outer walls of the structures, the middle axle has been completely transformed into a student-oriented living center. Thanks to the open space constructions, the building density was lightened and attention was paid to the fact that pedestrian traffic in different directions was continuous and fluid, and different perspectives were presented within area. Thanks to the intersection points of randomness as a phenomenon in the project, it has been turned into a meeting point for people. However, in order to have a canopy in hot weather conditions, pergolas were used in open areas. The pergolas have been integrated into the project by observing the vertical-horizontal balance of the existing layout plan. This axis of the social spine, designed as the center and breathing point of socialization, was directed to the current stream and water-nature integrity was established. At the same time, it was possible to establish a relationship between different buildings in the campus as a center of attraction.





KAHRAMANMARAS PAZARCİK 125 BED STATE HOSPITAL

It is a 125-bed state hospital project with a construction area of approximately 28800 square meters, planned to be built within the borders of Pazarcık district of Kahramanmaraş province. Emergency Service, Polyclinic, Operating Room, Palliative Care Unit, Burn Unit, SdI, Intensive Care Unit, Delivery Room, Chemotherapy, Dialysis, Dental Polyclinic and Blood Center were designed in the hospital. An open parking lot for 259 vehicles and a helpist were arranged within the boundaries of the land. An open parking lot for 259 vehicles and a helpist were arranged within the boundaries of the land.

Project Information

Land Area: 25.002.18 m²

Building Area: 5055.02 m²

Number of Floors: B+Z+5+D

Total Construction Area: 28,802,46 m²

Construction Type: Reinforced Concrete





KONYA HUYUK 25 BED STATE HOSPITAL

It is planned to be built within the borders of Hüyük district in Konya province. It is a 25-bed state hospital project with a construction area of approximately 6,000 square meters. The hospital, which includes emergency service, polyclinic, dialysis, dental polyclinic, operating room, burn unit, consists of 2 blocks. An open parking lot for 60 vehicles and a helipist were designed within the boundaries of the land.

Project Information

Land Area: 14,868.25 m²

Building Seating Area: 1670,42 m²

Number of Floors: B+Z+2+D

Total Construction Area: 6027.39 m²

Construction Type: Reinforced Concrete





RTUK ISTANBUL REGIONAL REPRESENTATIVE OFFICE SERVICE BUILDING

It is a project of the Rtuk Istanbul Regional Representative Office Service Building with a construction area of about 2000 square meters, planned to be built in Besiktas district of Istanbul province. It consists of a total of 9 floors, including 2 basement floors plus 6 floors. In order to provide a more spacious working environment for its users and to make more use of daylight, units have been designed that can be used as open offices. In addition, two meeting rooms have been designed where members of the upper board can hold meetings and can be used at press conferences.

Project Information

Land Area: 525.46 m2

Building Floor Area: 220.77 m2

Number of Floors: 2B+Z+6

Total Construction Area: 1986.27 m2

Construction Type: Reinforced Concrete

Decking Area: 2B+Z+6

Total Construction Area: 1986.27 m2





TOKAT FAMILY SERVICE BUILDING OF THE PROVINCIAL DIRECTORATE OF LABOR AND SOCIAL SERVICES

Tokat province is a Service Building project planned to be carried out within the boundaries of Topçubaşı District, with a construction area of about 5,400 square meters, the Coordination Center of the Provincial Directorate of Family, Labor and Social Services, the Directorate of Social Services and Children's Homes. The Dec canal and the memorial tree located within the boundaries of the plot are designed to be protected. an outdoor parking area for 40 cars has been arranged.

Project Information

Land Area: 6.990.12 m²

Building Area: 1.454,10m²

Number of Floors: B+Z+2

Total Construction Area: 5.432.35 m²

Construction Type: Reinforced Concrete





TOKAT INTERNATIONAL FRESH VEGETABLES AND FRUIT CASE

Tokat International Wholesale Fresh Vegetable and Fruit Market Hall Project was designed by the Tokat-Turhal-Zile-Pazar Municipalities International Wholesale Market Facilities Management Association (TUHAB) to cover an area of approximately 300,000 square meters. It is envisaged that construction will be carried out with a closed area of approximately 96.480 m2. In the project, broker units, merchant municipalities, hotel building, administration building, mosque, bazaar, gas station, slaughterhouse, cold storage, drying oven should be in a state complex such as all units are designed. an open parking area of 17000 square meters is planned.

Using Status

- Broker Unit - 198 units
- Merchant Warehouse - 52 Pieces
- Administration Building-R&D-Laboratory - 3368 m2
- Bazaar - 36 Shops
- Auction Area-Market Place - 10632 m2
- Packing Area - 1800 m2
- Cold Storage - 2724 m2
- Drying Oven - 2045 m2

- Fire Department - 430 m2
- Case Warehouse Washing - 1375 m2
- Garbage Collection Area - 4400 m2
- Hotel - 48 Persons
- Mosque - 1500 people (with courtyard)
- Gas station - 1500 m2
- Weighbridge - 4 Pieces
- Parking lot - 17000 m2



MARMARA HIGH-TECH AND MACHINERY SPECIALIZED ORGANIZED INDUSTRIAL ZONE ZONING PLAN'

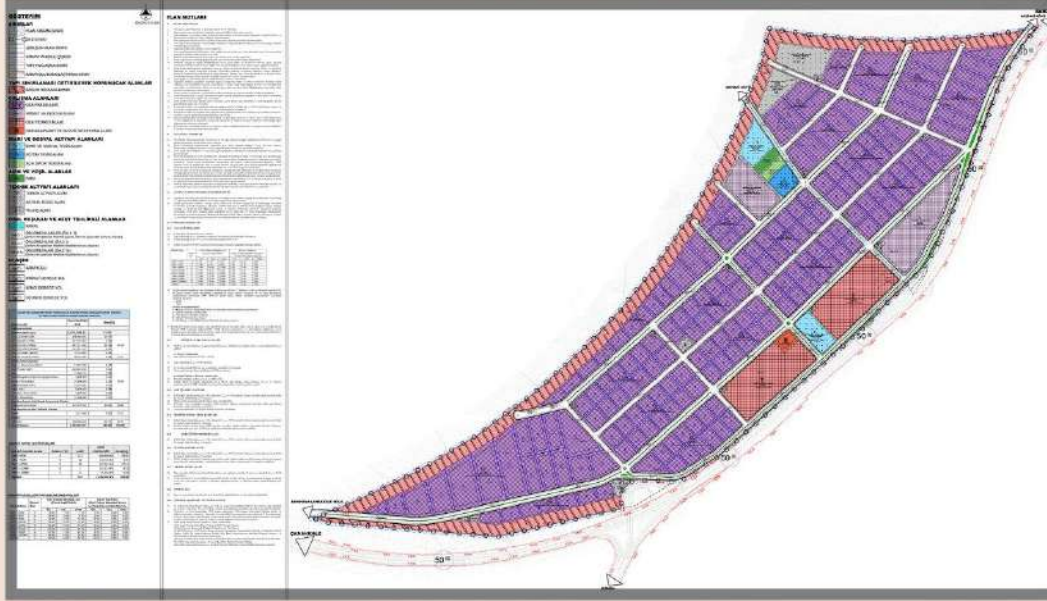

The planning area consists of a total area of 2,202,939 m². In industrial areas, E=100 Maximum Construction Height on a Plot: Unrestrained (height required by the production technology). In addition the setback distance of the industrial parcels in the area are regulated according to the "Organized Industrial Zones Zoning Plan Specification" published in the Official Gazette dated 06.08.2020 and numbered 30854. The common areas belonging to the Organized Industrial Zone Area are 255,378.95 m² and approximately 11.59% of the area has been allocated. The Organized Industry Directorate is authorized to implement and supervise the plan notes in the field of planning, and the provisions of the Organized Industrial Zones Law No. 4562, the Zoning Law No. 3194, the Organized Industrial Zone Implementation Regulation, the Organized Industry Zoning Plan Specification and the Spatial Plans Construction Regulation shall be complied with.

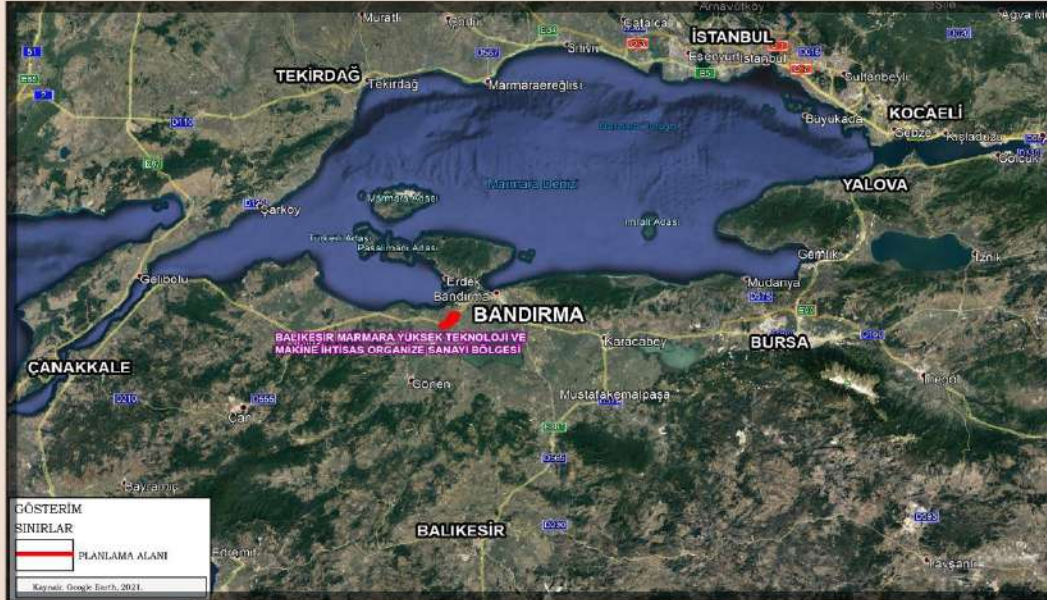

Plan Türü	MARMARA YÜKSEK TEKNOLOJİ VE MAKİNE İHTİSAS OSB İMAR PLANI
Planlamayı Yaptıran Kuruluş/Firma	MARMARA OSB
Alan Büyüklüğü	220 HA
İşe Başlanma ve Bitiş Tarihi	-----
Onay Kurumu	T.C. SANAYİ VE TEKNOLOJİ BAKANLIĞI
Nazım İmar Planı Plan Onama Tarihi	ONAY AŞAMASINDA

ISTANBUL PROVINCE, FATİH DISTRICT, SIRKECI "CAR FERRY AND SEA BUS PIER" ZONING PLAN

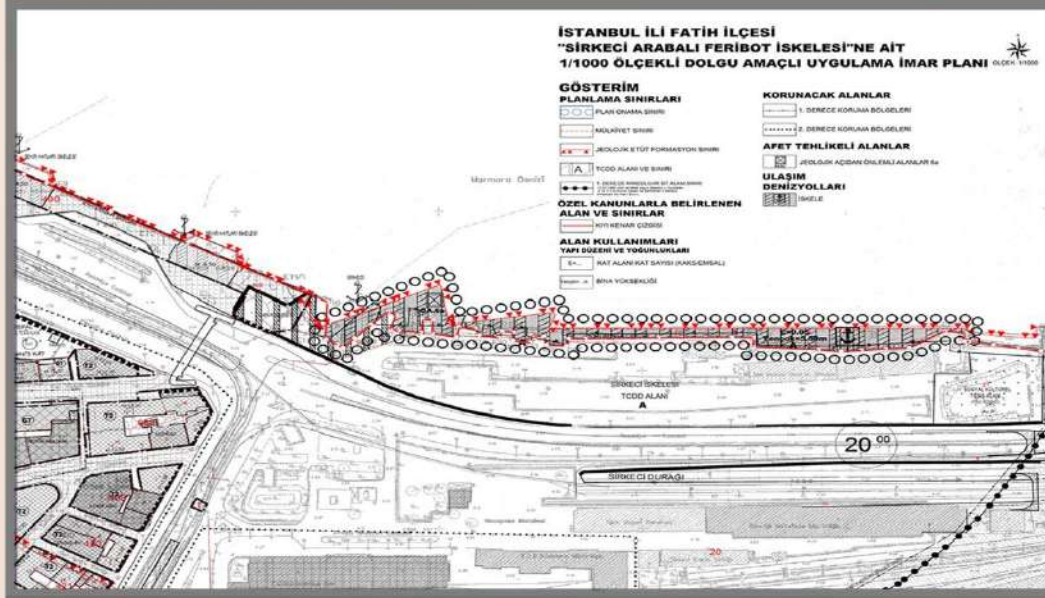

Regarding the land side of the coastal edge line of the area used for vehicle and passenger transportation on the Sirkeci-Harem line, Istanbul Province, Fatih District, HocaPaşa Neighborhood, 1 sheet, 1 block, 20 parcels (old 13-old 19 parcels); Regarding the plan that was decided to be canceled for the relevant parcel; It is aimed to determine the precedent value of the pier function and what uses can be made in the superstructure, as the sea side of the coastal edge line needs to be re-considered and a zoning plan for the pier area arises. Construction Conditions in the area of 0.33 ha in total are Precedent=0.05 Maximum Construction Height on a Plot: =5.50 m. The "Car Ferry and Sea Bus Pier Area" function has been proposed for the area within the plan approval limit. Superstructures needed for the use of ferryboats and sea bus piers within the planning area and as a complement to this use can be built within the scope of the facilities defined in the Regulation on the Implementation of the Coastal Law.

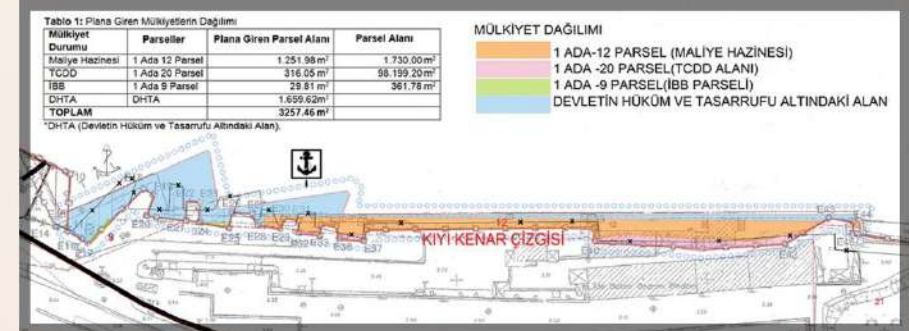
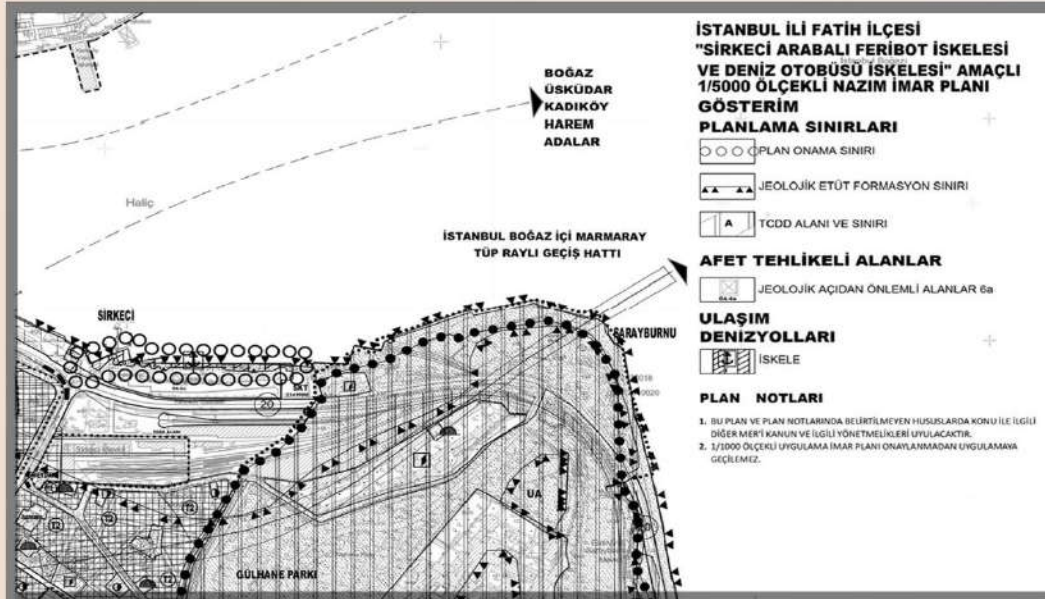
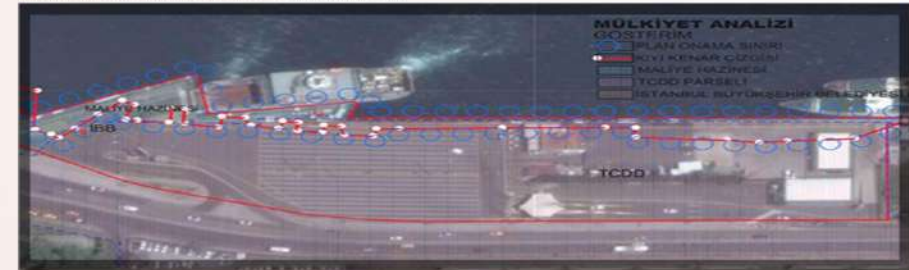

Plan Türü	İskele Amaçlı İmar Planı
Planlamayı Yaptıran Kuruluş/Firma	İstanbul Deniz Otobüsleri (İDO) A.Ş
Alan Büyüklüğü	0.33 ha
İşe Başlanma Tarihi	04.01.2012
Onay Kurumu	Çevre ve Şehircilik Bakanlığı
Plan Onama Tarihi	07.09.2017/15556

KOCAELI PROVINCE, DILOVASI DISTRICT, TAVŞANCIL 1 NEIGHBORHOOD, ZONING PLAN FOR THE PORT AREA

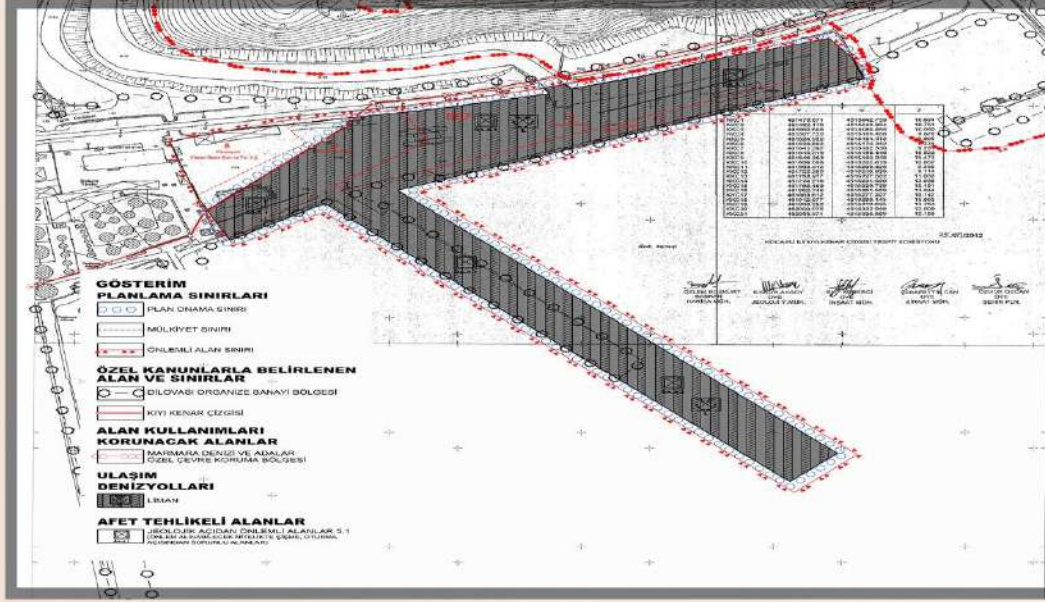

The planning area is located in the area of approximately 29,073.16 m², which is located in the Kocaeli Province, Dilovasi District, Tavşancıl 1 Neighborhood, 657 Islands, 9, 10 and 11 Parcels, and some of which are under the Provision and Protection of the State. The mentioned areas belong to the treasury of finance and are used as a "Port Area" by Efesan Demir Sanayi ve Ticaret. The entire planning area has been defined as the "Port Area". Construction conditions, technical and social infrastructure facilities, management, support, maintenance-repair and storage units can be made in the port area, and the construction conditions in the management and support units are Precedent: 0.50, Maximum Construction Height on a Plot: 6.50 Meters. For structures other than management and support units, it will be Maximum Construction Height on a Plot: 21.50 meters.



Plan Türü	LİMAN AMAÇLI İMAR PLANI
Planlamayı Yaptıran Kuruluş/Firma	EFESAN DEMİR SANAYİ VE TİCARET A.Ş.
Alan Büyüklüğü	29.073.16 M2
İşe Başlanma ve Bitiş Tarihi	-----
Onay Kurumu	T.C. SANAYİ VE TEKNOLOJİ BAKANLIĞI
Nazım İmar Planı Plan Onama Tarihi	ONAY AŞAMASINDA

DILOVASI ORGANIZED INDUSTRIAL ZONE II. MODIFICATION OF THE STAGE (TAVSANCIL PART) SECTION AND IMPLEMENTATION ZONING PLAN

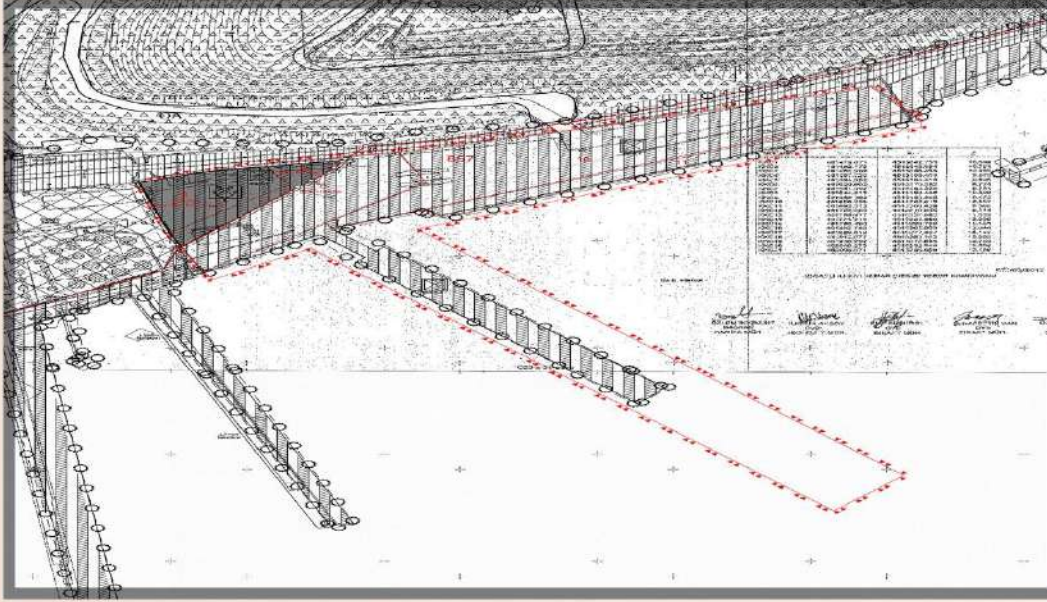

As a result of the evaluation of the plan change request in accordance with the Organized Industrial Zones Law No. 4562 and the Organized Industrial Zones Implementation Regulation, the Zoning Law No. 3194 and related regulations; The planning area of 3413 m², including 2,277,16 m² of the 657 block 8 parcel and 1135.84 m² of the 657 block 9 parcel, has been planned as the "Port Area".

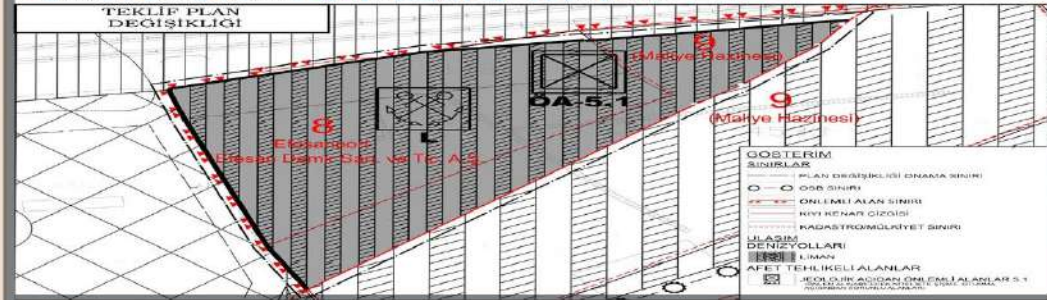
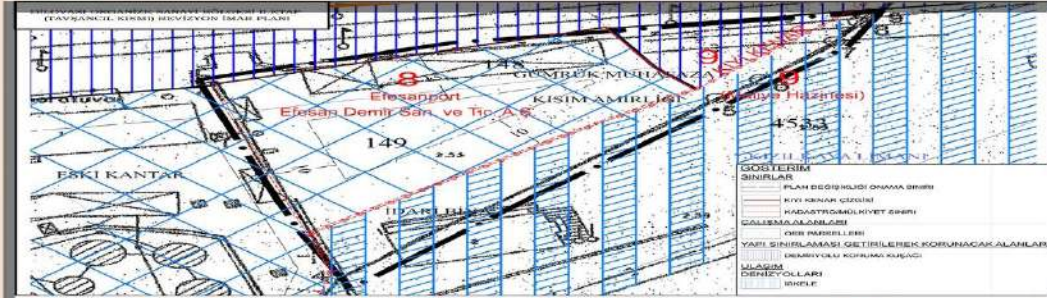

Plan Türü	ORGANİZE SANAYİ İMAR PLANI DEĞİŞİKLİĞİ
Planlamayı Yaptıran Kuruluş/Firma	EFESAN DEMİR SANAYİ VE TİCARET A.Ş.
Alan Büyüklüğü	3413 M2
İşe Başlanma ve Bitiş Tarihi	-----
Onay Kurumu	T.C. SANAYİ VE TEKNOLOJİ BAKANLIĞI
Nazım İmar Planı Plan Onama Tarihi	ONAY AŞAMASINDA

İSTANBUL PROVINCE, ÜSKÜDAR DISTRICT, HAREM FERRY AND SEA BUS PORT ZONING PLAN



The function of "Car Ferry and Sea Bus Pier Area" has been proposed for the area within the plan approval limit. The construction conditions in the pier area are Precedent=0.04 Maximum Construction Height on a Plot: =5.50m. Administrative buildings, offices, ticket offices, passenger waiting room, generator room, toilet, buffet, cafeteria that should be located for ferry and sea bus operation activities can be made within the planning area. The existing pier structure and coastline contours have been preserved exactly in the proposed plan, and no additional infill areas have been proposed. The construction conditions and the decisions taken are indicated in the plan notes. The provisions of the Zoning Law No: 3194 and Related Regulations, the Ports Law No. 618, the Decree Law No. 655 on the Organization and Duties of the Ministry of Transport, Maritime Affairs and Communications were complied with.

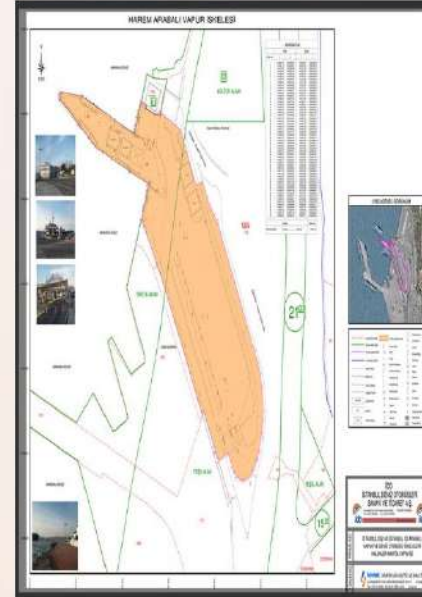

Plan Türü	İskele Amaçlı İmar Planı
Planlamayı Yaptıran Kuruluş/Firma	İstanbul Deniz Otobüsleri (İDO) A.Ş
Alan Büyüklüğü	1.56 ha
İşe Başlanma Tarihi	04.01.2012
Onay Kurumu	Çevre ve Şehircilik Bakanlığı
Plan Onama Tarihi	3.05.2016/7247

PROTECTED ZONING PLAN AND CHANGE FOR THE "KOCAELİ PROVINCE GEBZE DISTRICT ESKİHİSAR NEIGHBORHOOD" ESKİHİSAR FERRY PIER

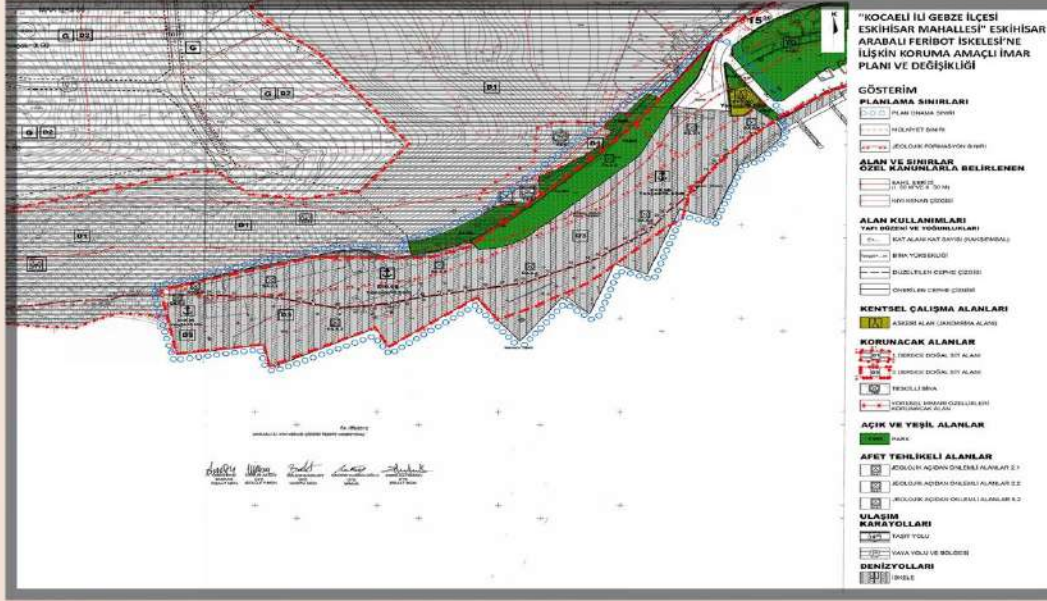

In addition, in the area owned by the Treasury of Finance in the meri plan and granted the right of use to the Maritime Enterprises of Turkey (transferred to the Istanbul Metropolitan Municipality), parking has been arranged in the area located to the north of the pier area so that the parts remaining in the green area in the meri plan will again be equivalent in size. In the case of the development situation related to these structures, the construction conditions in the background were determined as Precedent = 0.06 Maximum Construction Height on a Plot: = 5.50m.



The "Car Ferry Pier Area" function has been proposed for the area within the plan approval limit. There may be administrative buildings, offices, ticket offices, passenger waiting room, generator room, toilet, buffet, cafeteria in the pier area that should be located for the operation of car ferry operation. The total construction area of the existing structures is 2.262 m² and the planned pier area is 45.371 m² and the Precedent is=0.05 according to the current situation.

Plan Türü	İskele Amaçlı İmar Planı
Planlamayı Yaptıran Kuruluş/Firma	İstanbul Deniz Otobüsleri (İDO) A.Ş.
Alan Büyüklüğü	5.92 ha
İşe Başlanma Tarihi	04.01.2012
Onay Kurumu	Çevre ve Şehircilik Bakanlığı
Plan Onama Tarihi	28.11.2017/14277

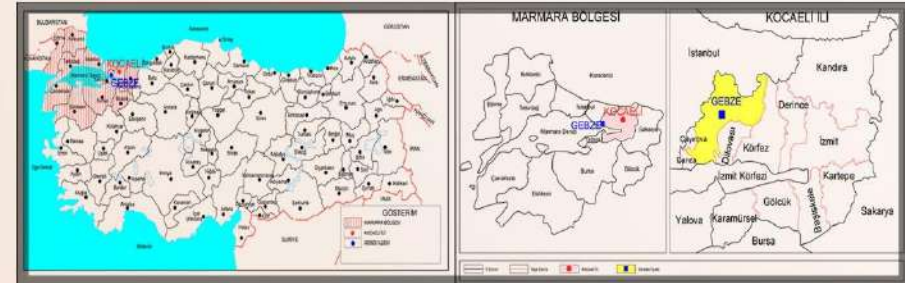

SİVAS PROVINCE KANGAL AND GÜRÜN DISTRICTS KANGAL WIND POWER PLANT (WPP) PROJECT ZONING PLAN AND CHANGE

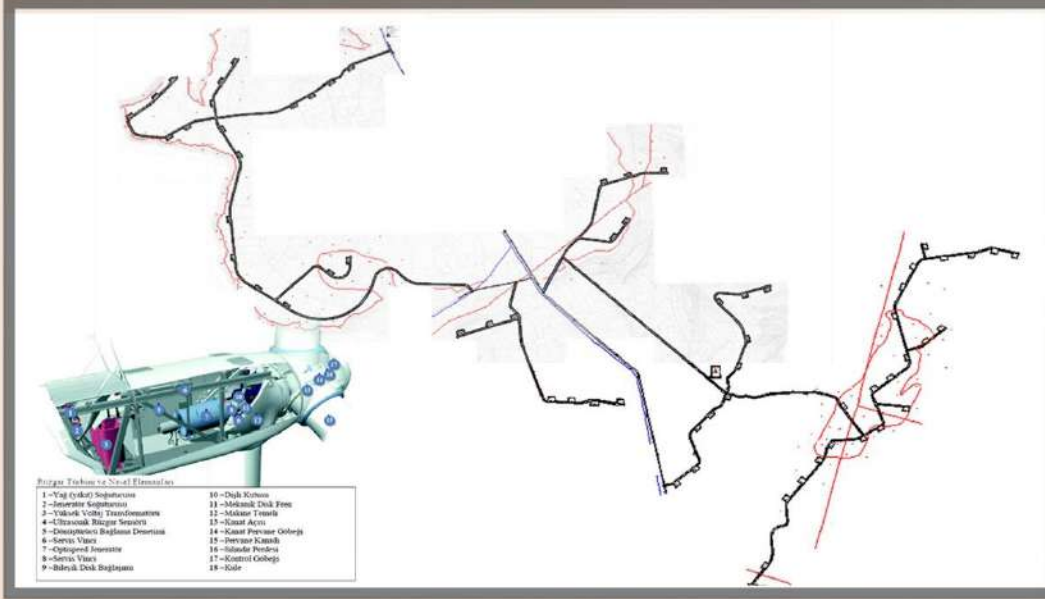

JUSTIFICATION OF PLAN CHANGE

Within the framework of the work carried out for the tribune places remaining within the scope of the project, the tribune locations were re-evaluated, and within this framework, taking into account the coordinates of the new tribune number 40, which is out of the previously approved zoning plan, and the road connection connecting the tribune area to the Kangal-Gürün road, a 2-sheet application zoning plan plan change has been made. Other tribunes have also been relocated, but since the tribunes in question remain within the Tribune areas specified in the previously approved zoning plan, they were not shown as a change in the plan study.

It is a 128 MW Kangal Wind Power Plant to be built in Kangal and Gürün Districts located on the border of Sivas province. Kangal Wind Power Plant (RES), located within the boundaries of Kangal and Gurun districts of Sivas Province, has been approved by the Sivas Provincial Special Administrative Council by decision No. dated 04 dated 08.01.2014 after receiving the opinions of the relevant institutions and organizations. Within the scope of the Kangal Res Project, it is aimed to install 64 Wind Bleachers with a capacity of 2 MW each. In accordance with the zoning plan approved within the scope of the project, the installation of 22 bleachers has been completed and electricity generation has been started. The Construction Conditions in the Switchgear Center and Switchgear Control Building Area are Precedent=0.20 Maximum Construction Height on a Plot: = 6.50 m.

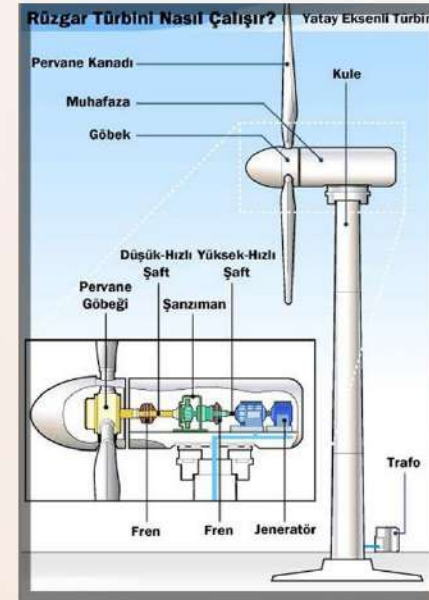

Plan Türü	Rüzgar Enerjisi Santral Alanı (RES) İmar Planı
Planlamayı Yaptıran Kuruluş/Firma	Kar-Map Harita Emlak Proje Müh. Müş. San. ve Tic. Ltd. Şti.
Alan Büyüklüğü	150 Ha
İşe Başlanma ve Bitiş Tarihi	2013-2014
Onay Kurumu	Sivas İl Özel İdaresi
Plan Onama Tarihi	08.01.2014/4
Plan Değişikliği Onama Tarihi	07.03.2014/32



ALANYA DISTRICT OF ANTALYA PROVINCE-KONYA PROVINCE HADİM DISTRICT SEYHLER VILLAGE LOCATION LONELARDIÇ DAM BERAT HYDROELECTRIC POWER PLANT AREA ZONING PLAN

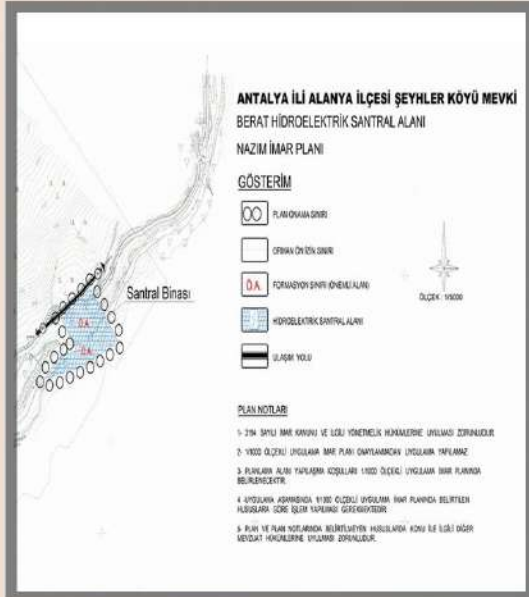
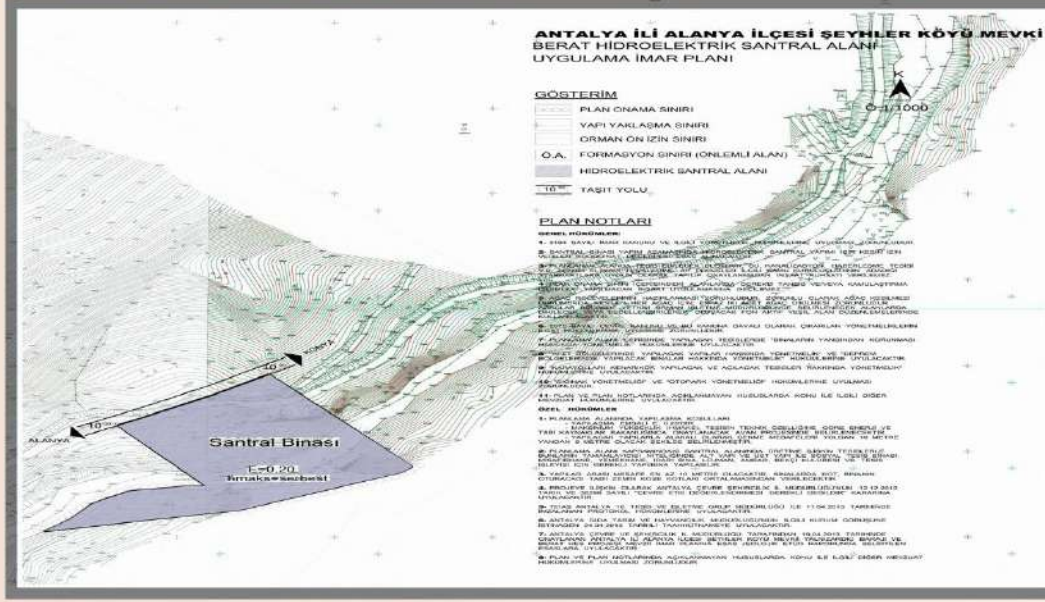

PLAN DECISIONS

The construction conditions in the power plant area have been determined as $Precedent=0.20$, and the maximum height will be determined by the preliminary project to be approved by the Ministry of Energy and Natural Resources, according to the technical characteristics of the facility. Towing distances were determined to be 10 meters from the road and 5 meters from the side. The area of the power plant is determined as 18,324.58 m² in the plan. In addition, the roads that will provide access to the facility are shown in the plan in a way that will provide connection to the existing roads in the area. The part between the service roads to be built in the area where the main power plant is located and these structures is shown as forest area in the plan, since no undefined area can be left in the zoning plans and it is under forest property.

The location of the Yalnızardıç Dam and Berat Hydroelectric Power Plant Project, which is one of the projects developed within the scope of meeting the energy needs of our country, was determined by taking into account many factors such as climate, precipitation, geology, ground condition, environment, topography, transportation, and property, and was designed after extensive and detailed engineering studies has been projected. The scope of the plan is the Lonardıç Dam and the Berat Hydroelectric Power Plant with a power of 32.5 MW, which will be built on the Gevne stream in the Göksu River basin located on the provincial border of Antalya. The planning area is outside the boundaries of the municipality and the application area and is under the responsibility of the Antalya Provincial Special Administration.

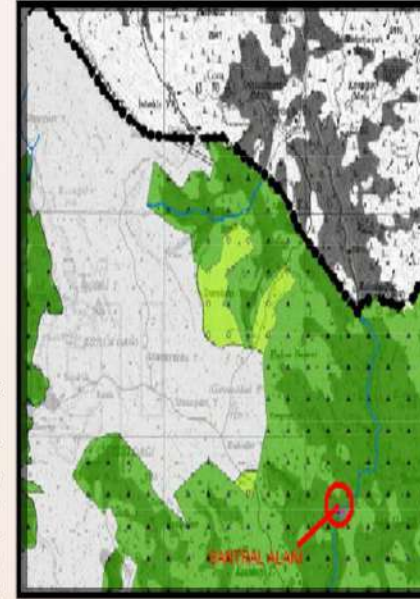

Plan Türü	Hidroelektrik Santral Alanı (HES) İmar Planı
Planlamayı Yaptıran Kuruluş/Firma	Albe En. Elek. Dan. Müş. Pet. Mad. Tar. San. Tic. A.Ş
Alan Büyüklüğü	1.83 Ha
İşe Başlanma ve Bitiş Tarihi	09.01.2012-2015
Onay Kurumu	Antalya İl Özel İdaresi

ANKARA PROVINCE KAZAN DISTRICT IGNE NEIGHBORHOOD, 125 CITY BLOCK, 17 PARCELS UNLICENSED SOLAR POWER PLANT (GES) PROJECT ZONING PLAN

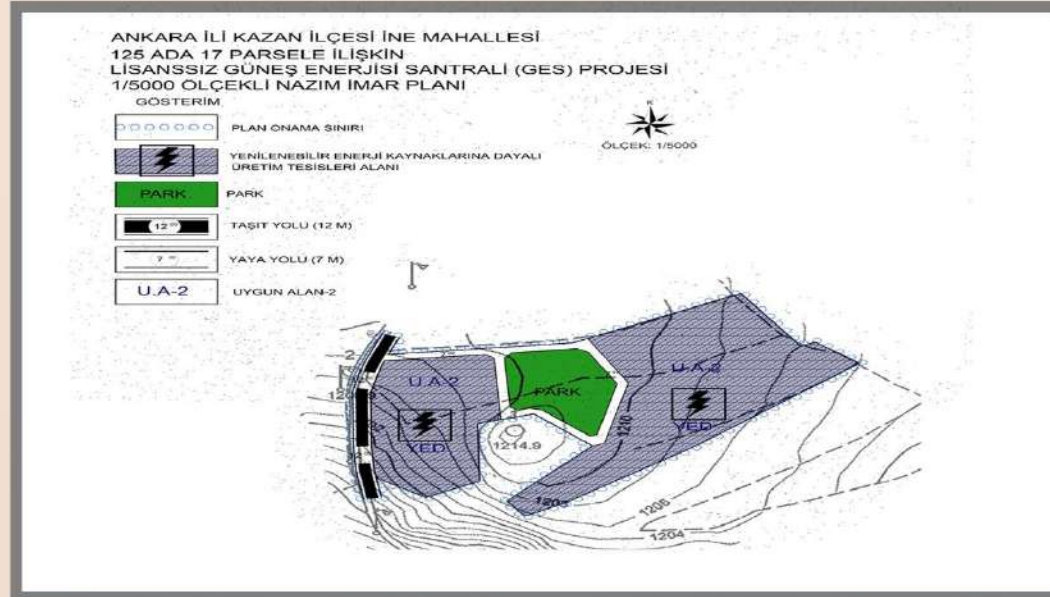
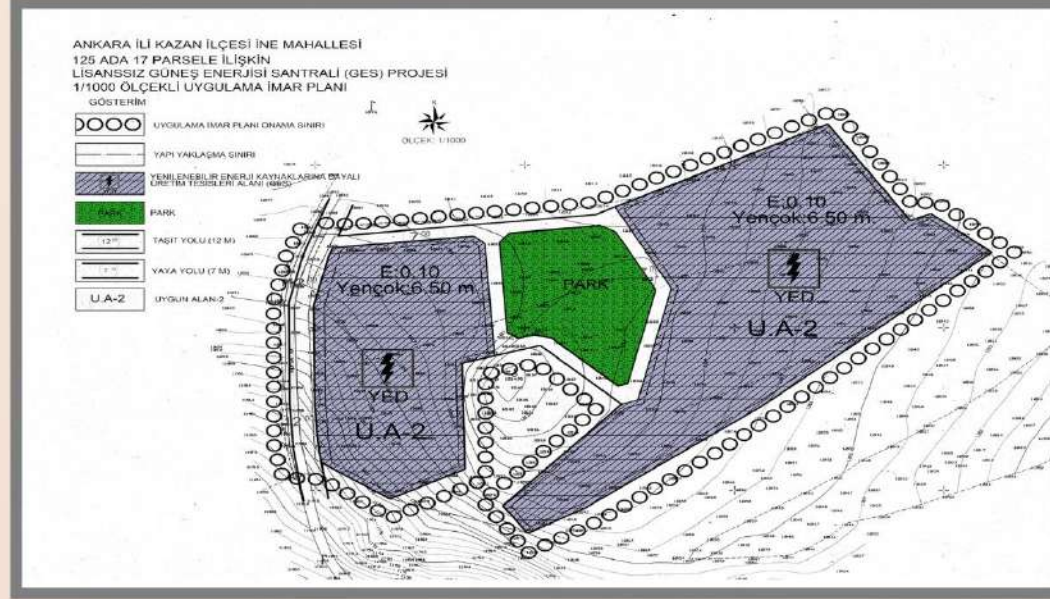

Planning area is 125 lot and 17 parcel located in Ankara Province Kazan District Igne neighbourhood section no H29-D-02-D of 1/5000 and section no H29-D-02-D-4-B, H29-D-02-D-4-C of 1/1000.125 islands located on the sheets of 17 no.lu it's a parcel. 32.635 m2 of the Planning Area consists of an Electricity Generation Area Based on Renewable Energy Sources, a Parking Area of 5048 m2 and 3.177 m2 of roads. A "Solar Power Generation Plant" function has been proposed for the area within the plan approval limit. Construction conditions Administrative Facility v.b. E = 0.10 for the structures and Maximum Construction Height on a Plot: 6.50m for the other technological structures Maximum Construction Height on a Plot Will be as much as the technology Requires has been proposed.



Plan Türü	Lisanssız Güneş Enerjisi Santrali (GES) Projesi
Planlamayı Yaptıran Kuruluş/Firma	Yentek Elektrik Enerji Mühendislik Tic. AŞ.
Alan Büyüklüğü	4.08 Ha
İşe Başlanma ve Bitiş Tarihi	14.03.2016-2018
Onay Kurumu	Ankara Büyükşehir Belediyesi
Nazım İmar Planı Plan Onama Tarihi	12.07.2017/1377

ISTANBUL PROVINCE SARIYER DISTRICT ISTI NYE FERRY AND SEA BUS PIER ZONING PLAN CHANGE



There are no cadastral plots in the planning area, and 442.69 m² of its property belongs to the General Directorate of National Real Estate under the contract, and 186.54 m² of the area belongs to the Istanbul Metropolitan Municipality. Istinye Pier, approved by the Boğaziçi Zoning Directorate of the Istanbul Metropolitan Municipality with the decision No. 8539 on 22.07.1983, remains within the Boundaries of the Boğaziçi Natural and Historical Values Zoning Plan, Pre-View Zone Implementation Zoning Plan. The function of "Ferry and Sea Bus Pier Area" has been proposed for the area within the plan approval limit. The construction conditions in the pier area will be Precedent=0.15 Maximum Construction Height on a Plot: 5.50 m. Administrative buildings, offices, ticket offices, passenger waiting room, generator room, toilet, buffet, cafeteria that should be located for ferry and sea bus operation activities can be made within the planning area.

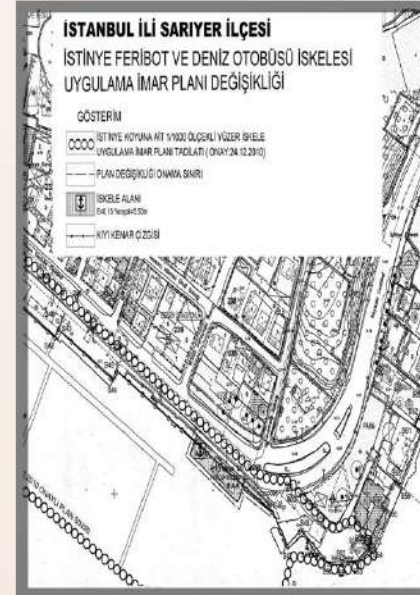

Plan Türü	İskele Amaçlı İmar Planı
Planlamayı Yaptıran Kuruluş/Firma	İstanbul Deniz Otobüsleri (İDO) A.Ş
Alan Büyüklüğü	0.06 ha
İşe Başlanma Tarihi	04.01.2012
Onay Kurumu	Boğaziçi İmar Yüksek Koordinasyon Kurulu
Plan Onama Tarihi	Onay Aşamasında

Dünyanın ve ülkemizin gelişimiyle birlikte artan enerji ihtiyaçlarını düşünerek, dünyada artan yeşil enerji yatırımlarında yer almak ve Paris İklim Anlaşması ile dünyanın yeşil enerji dönüşümünden pay almak adına 2021 Eylül ayında şirketimizin de kurucusu olduğu **MCA YENİLENEBİLİR ENERJİ YATIRIM SAN. VE TİC. A.Ş.** kurucu ortak olarak yer almış ve yenilenebilir enerji yatırımlarına yönelik proje geliştirme, uygulama ve işletme süreçlerine yönelik çalışmalara başlamıştır. MCA Enerji olarak; Ülkemizin önde gelen Şirketlerinden Nuh Çimento, Efesan Grup ve Koç Holding iştiraki Entek Elektrik ve Ford Otomotiv A.Ş gibi şirketlerle halihazırda yenilenebilir enerji projeleri yürütmektedir.

Considering the increasing energy needs with the development of the world and our country, to be involved in the ever-increasing green energy investments and to take a share in the green energy transformation of the world with the Paris Climate Agreement, **MCA YENİLENEBİLİR ENERJİ YATIRIM SAN. VE TİC. A.Ş.**, of which our company is the founder, took place as a founding partner in September 2021 and started to work on project development, implementation and operation processes for renewable energy investments. As MCA Enerji, we currently carry out renewable energy projects with leading companies in our country such as Nuh Çimento, Efesan Group, Ford Otomotiv A.Ş and Koç Holding subsidiary Entek Elektrik.

دديازتملوا ةحللملا ةجالحا رابتعلا رظنبا ذخال دنعو كوتسم ىلع ناك نا ءاوس ىراجلا روطتلا عم ةقائلل لوصحلا لجا نم لكذكو ، ملعلا كوتسم ىلع وا اندلب ىراجلا ملعلا ىف ءارضحلا ةقائلل لوحت نم ةصح ىلع ،خانملا سىراب ةىقافتا ذىفنت راطا ىف لاجم ىف ةىراجلا تارامثتساللا ىف ةكراشملا ،موي دعب اموي ملعلا ىف دديازتملا ءارضحلا ةقائلل ةددجتمللا ةقائلل " MCA ىا ىس ما " ةكرش تعرش ةمهاسملا ةراجتلاو ةعانصلو رامثتسالو " **MCA YENİLENEBİLİR ENERJİ YATIRIM SAN. VE TİC. A.Ş** " ةكرشلا انتكرش ربعتت ىتلا " 2021 ربمببس /لوليا رهش ىف ، ةسسؤملا رىوطتو ، زاجناو ذىفنتو ، لىغشت لجارم ىف لمعلا ةددجتمللا ةقائلل تارامثتساب ةقلعتملا عىراشملا سسؤملا كىرشلا ةفصب اهىف دجاوتت ىتلاو ؛ ةددجتمللا ةقائلل " MCA ىا ىس ما " ةكرش نا امك ةددجتمللا ةقائلل عىراشم زاجناو ذىفنتب موقت ةدئارلا تاكرشلا عم رضاحلا انموي ىلا ةمرتسملاو تنمسالل " Nuh جون ةكرش " ، اهنمو اىكرت ىف " ءابرهكلل " Entek كتنا " ةكرشو ، " Nuh Çimento " تاراسملا ةعانصل " Ford دروف " و " Entek Elektrik " ةومجمل ءاكرشلاو ، " Ford Otomotiv A.Ş " ةمهاسملا " ةكرشو " Efesan Grup " " Efesan ناسىف " " Koç Holding " ةضباقلا " Koç شتوك

**nuh**
çimento grubu**ENTEK****FORD OTOSAN****Koç****EFESAN**
GRUP

2020 yılı kuruluş sürecinden bu yana, planlama ve fizibilite çalışmalarında yer alınan Balıkesir ili Bandırma ilçesinde kurulan Marmara Yüksek Teknoloji ve Makine İhtisas OSB içerisinde kurulmuş ve 5.000 m2lik ön tahsisi yapılan sanayi parseli üzerinde, **ACS MARMARA İNŞ. İTH. İHR. SAN. TİC. A.Ş.** olarak Türkiye ve Dünya ekonomisindeki gelişmeleri de dikkate alarak yerli ve milli üretimin yanında ihracat yapılması hedeflenmektedir.

Since the foundation in 2020, as **ACS MARMARA İNŞ. İTH. İHR. SAN. TİC. A.Ş.**, which has been involved in planning and feasibility projects and established on a pre-allocated industrial parcel of 5,000 m2 in the Marmara High Technology and Machinery Specialized Organized Industrial Zone located in the Bandırma district of Balıkesir province, we aim to export along with the domestic and national production taking into account the economic developments of Turkey and the world.

ACS " ACS MARMARA İNŞ. İTH. İHR. SAN. TİC. A.Ş " سَأِيسِ يَأ " ةَكَرِشِ تَسِسَاتِ رْتَم 5000 ةِیَلَامَجَالِ اَهْتِحَاسِمِ غَلَبْتِ اُقْبَسْمِ ةَصْرِخْمِ ةِیَعَانِصِ ضِرَا كِلَعِ ، " ACS " اِیْجُولُونَكْتَلَا یِیْ ةَصْرِخْتَمَلَا ةَرْمَرْمِ ةَمْظَنَمَلَا ةِیَعَانِصَلَا ةَقْطَنَمَلَا نَمْرُو ، عَبْرَمِ ةَنْیَدْمَلَا ةَعِبَاتَلَا اَمْرِیْدَنَابِ ءَاضِقِ یِیْ اَهُؤَاشِنِیْ مَرْتِ یْتَلَاوِ تَالْأَلَاوِ ةِیَلَعَالَا اَهْسِیْسِ ةَرْتَفِ ذَنْمِ اَهْیِیْ یِوَدْجَلَاوِ طِیْطِخْتَلَا تَاسَارْدِ ءَارْجِیْ مَرْتِیْ شِیْجِ ، رِیْسِکِیَلَابِ اَهْتِصَبِ " ACS " سَأِيسِ يَأ " ةَكَرِشِ فِدَهَتُو ، رَضْرَاحَلَا اَنْمُوِیْ كِتْحُو ، 2020 مَرَا عِ یِیْ یَنْطُولَا یِلْحَمَلَا جَاتِنَالَا كِلِیْ ةَفَاضِلَابِ رِیْصَتَلَا تَايِلْمَرِ ءَارْجِیْ كِلِیْ ، ةِیْصِخْشَلَا یِمْلَعَالَاوِ یِیْ كِرْتَلَا دَاصْتَقَالَا یِیْ ةِیْرَاجَلَا تَارُوْطَلَا رَابْتَعَالَا رَظْنَبِ ذَخَالَا عَمِ .





ENR İLAÇ MEDİKAL SAĞLIK TURİZMİ İTH. İHR. SAN. TİC. A.Ş.

Yine içinden geçtiğimiz pandemi süreci sonrası; insan hayatının temel ihtiyacı olan sağlık hizmetinin tüm aşamalarının en hızlı, en etkili, en kapsamlı ve en kolay ulaşılabilir şekilde olmasını sağlamak ve ilaç temini, nitelikli sağlık hizmeti sunmak gayesiyle 2022 Ağustos ayında **ENR İLAÇ MEDİKAL SAĞLIK TURİZMİ İTH. İHR. SAN. TİC. A.Ş.** bünyesinde ortak olarak yer alarak sağlık alanındaki yatırımlara başlanmıştır. A gurubu seyahat Acentası belgesi sahibi olarak Sağlık Turizmi hizmetleri verme imkanına sahip olan şirketimiz yine Türkiye İlaç ve Tıbbi Cihaz Kurumu'ndan 2023 yılı Eylül ayında alınan ruhsat ile Ecza deposu da hizmet girmiş ve ilaç ve medikal ürün ticaretine başlanmıştır.

In the aftermath of the pandemic, with the aim of ensuring that all stages of health care, which is the basic need of every human, are provided in the fastest, most effective, most comprehensive and most accessible way, and to provide medication supply and qualified health care services, we became a partner of **ENR İLAÇ MEDİKAL SAĞLIK TURİZMİ İTH. İHR. SAN. TİC. A.Ş.** in August 2022 and started to invest in the field of health. Our company, which has the opportunity to provide Health Tourism services as a Group A Travel Agency certificate holder, has also introduced a pharmaceutical warehouse service with the license obtained from the Turkish Medicines and Medical Devices Agency in September 2023 and started to trade pharmaceuticals and medical products.

فدهب و؛ انوروك ءابو ٲشفت ءلحرم دعبو ، ٲرخا ءرمو ٲتلا ، ءٲحصللا ءٲاعرلا لءارم عٲمء مرٲدقت نامض ءاٲءل ءبسنلاب ءءلمو ءٲسأسا ءءاء ربءءء ءٲلءاعف اءرءءا ءو ، ءرءلا لهسأب و عرسأب ، ناسنإلا ءامءءلا ءو ، ءٲءاوءلا ءاءاءمإل رٲفوء ءلءءو ، ءلومرشو ٲف لوءءلاب ءءبلا مرء هءاف ، ءلهءمءلا ءٲءحصللا 2022 بآ / سءسءا ٲف ءءحصللا لءاءم ٲف ءاراءءءسا ٲا " ءءرشو ءلظم ءءء ءءرشو ءفصء لوءءلا لءلء نم ءٲبءلا ءٲءحصللا ءءاٲسلا ءٲءءال ءنر " رآ نأ ءمهاسمءلا ءءاءءلا ءءانصلا ءرٲءصءءلا ءارٲءءسالا ءنر " **ENR İLAÇ MEDİKAL SAĞLIK TURİZMİ İTH. İHR. SAN. TİC. A.Ş.** مرٲدقت صرفب انءءرشو عءمءء امء. ءءاهشل ءلمءا ءءرءءءاب ءٲءحصللا ءءاٲسلا ءامءءءلا ءءاضا ، " A ٲا ءءومءمءلا " عون نم رفس ءلءو ءلءءو ، ءٲبءلا ءءاءءءمءلا ءٲءءال ءرءءءء ٲف ءءبلا ٲلء اهلوصء عم ءٲءءال ءءءمء ءاطءلا اهلوءء ءٲءرءلا ءٲبءلا ءزهءالا ءٲءءال ءلءو نم صٲءءرء 2023 رءمءبس / لولٲا ٲف

T.C.
KÜLTÜR VE TURİZM BAKANLIĞI
A GRUBU
SEYAHAT ACENTASI İŞLETME BELGESİ

BELGE NO : 15659
ÜNVANI : ENR ANKARA TRAVEL AGENCY
ADRESİ : MUSTAFA KEMAL MAH. 2084 SK. NO:3
CANKAYA/ANKARA
MERKEZİ : ANKARA
SAHİBİNİN ADI : ENR İLAÇ MEDİKAL SAĞLIK TURİZMİ
İTHALAT İHRACAT SANAYİ TİC. A.Ş.

Levent KIRCAN
Bakan a.
Genel Müdür Yardımcısı

Düzenleme Tarihi : 16.02.2023
Düzenleme Nedeni : YENİ BELGE

№ 044374

Bu belge 1618 Sayılı Seyahat Acentaları ve Seyahat Acentaları Birliği Kanunu uyarınca verilmiştir.

T.C.
SAĞLIK BAKANLIĞI
Türkiye İlaç ve Tıbbi Cihaz Kurumu

ECZA TİCARETHANESİ İZİN BELGESİ

İZİN NUMARASI : ET/2023/211

ECZA TİCARETHANESİ ADI : ENR İLAÇ MED. SAĞ. TURZ. İTH. İHR. SAN. TİC. A.Ş.
BALGAT ŞUBESİ.

ECZA TİCARETHANESİ ADRESİ : Balgat Mahallesi 1419. Caddesi No:7/C Çankaya / ANKARA

İZİN KAPSAMI : EK-1

YASAL DAYANAK : 984 Sayılı Ecza Ticarethanelerinde Sanat ve Zinat İşlerinde Kullanılan Zehirli ve Müessir Kimyevi Maddelerin Satışında Dükkanlara Mahsus Kanun
Ecza Ticarethaneleri ve Ecza Ticarethanelerinde Bulunduran Ürünler Hakkında Yönetmelik

ONAYLAYAN YETKİLİ : Dr. Asım HOCAOĞLU

TARİH : 10.09.2023

EK : EK-1 (Ecza Ticarethanesi izinin kapsamı)

Adres: SıĞırtılı Mahallesi 2176. Sok. No: 5/0520 Çankaya/ANKARA
Tel: (0312) 218 30 00 Fax: (0312) 218 34 60
1 / 2





T.C. BAŞBAKANLIK
TOki
TOPLU KONUT İDARESİ BAŞKANLIĞI



T.C. BAŞBAKANLIK
**ÖZELLEŞTİRME
İDARESİ
BAŞKANLIĞI**



nolte[®]
KÜCHEN

Kale

ŞERİFOĞLU

KOLEKSİYON

PERSAN
HOME STUDIO

TRESETTE
KITCHENS THAT INSPIRE

VitrA[®]

EGE PARKE

Häcker
kitchen.germanMade.

FRANKE

artella
exclusive doors

DENDRO
Lamine Parke

REHAU

ARTEMA[®]

E.C.A.[®]

OZAN PARKE

HÄFELE

REFERENCE AND PARTNERSHIPS..



CONTACT ANKARA

Mustafa Kemal Neighborhood, Barış Site, 2084. Street
Number:3 06520 Çankaya/ANKARA
Tel: 0312 466 14 18

info@sehreminiproje.com.tr

Urban Transformation, Planning and Consultancy
planlama@sehreminiproje.com.tr

Architectural Project and Construction
proje@sehreminiproje.com.tr

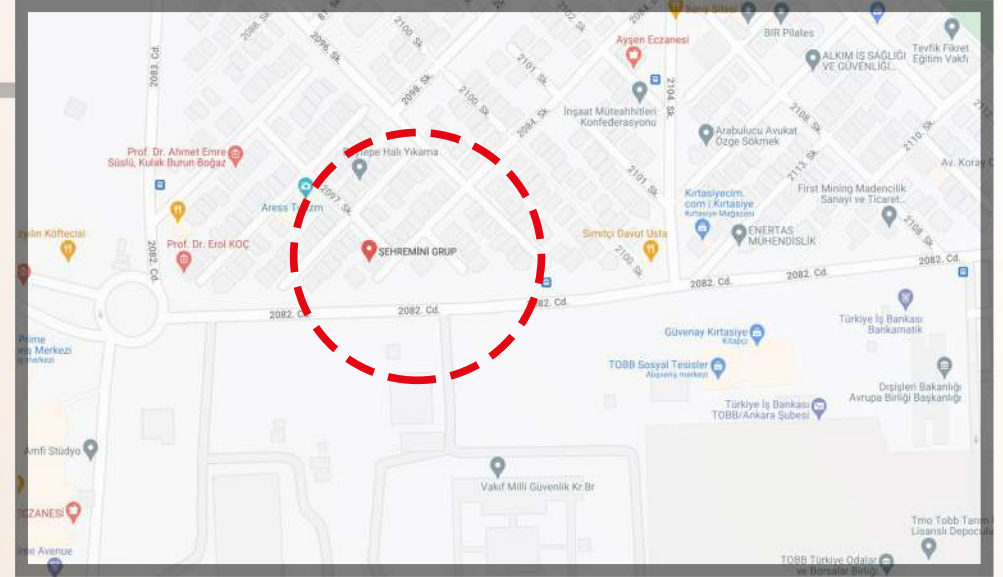

CONTACT ISTANBUL

Dudullu OSB Neighborhood, Imes Industrial Site, 504. Street
Block Number: 2
Imes Industrial Site Management Center
Ümraniye/İSTANBUL

